

# Model GS56DE REG

## DIAPHRAGM VALVES

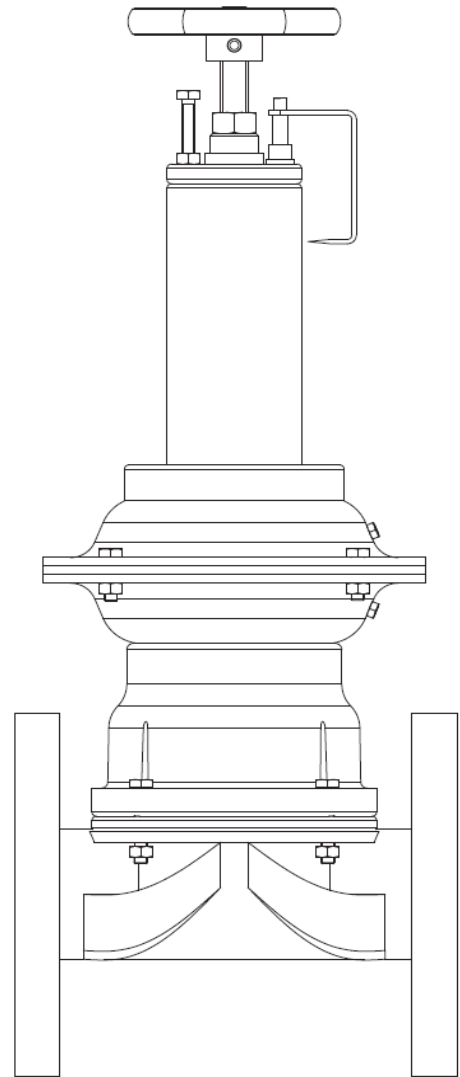

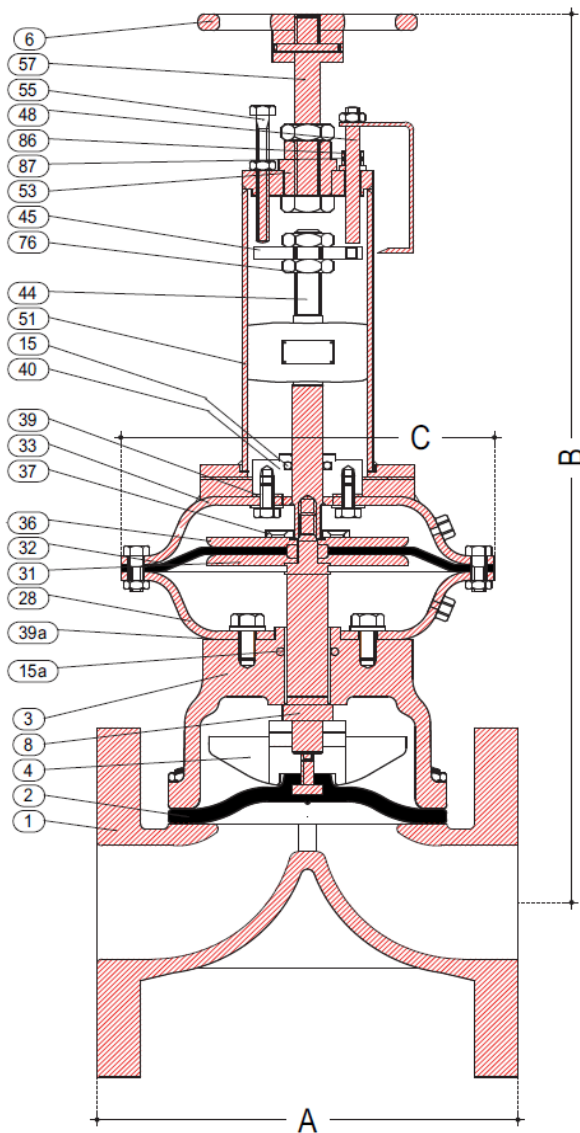

**DETAILS**

- 1 BODY
- 2 DIAPHRAGM
- 3 BONNET
- 4 COMPRESSOR
- 6 HANDWHEEL
- 8 STEM
- 15 O RING
- 28 BOTTOM CHAMBER
- 31 BOTTOM SUPPORT PLATE
- 32 AIR DIAPHRAGM
- 33 TOP CHAMBER
- 36 TOP SUPPORT PLATE
- 37 LOCKING WASHER
- 39 GASKET
- 40 SPRING SEAT
- 44 STEM EXTENSION
- 45 TOP PLATE
- 48 POSITION INDICATOR
- 51 SPRING CHAMBER
- 53 SLEEVE
- 55 LIMIT OPENING BOLT OR SCREW
- 57 SPINDLE
- 86 INDICATOR BUSH
- 87 O RING

**PRESSURE RATING**

refer technical data

**Unlined**

dn	15	20	25	40	50	65	80	100	125	150	200	250
Act Model	C		B									
BA13	170	125	135	145	170	185						
BA23	255			180	205	220	240	260	285	320		
BA33	338			205	230	245	265	285	310	340	395	480
BA63	415					290	310	335	365	415	500	
BA73	462						320	345	375	425	510	585
BA83	570						390	420	470	555	625	
	A											
	108	117	127	159	190	216	254	305	356	406	521	635

**Lined**

dn	15	20	25	40	50	65	80	100	125	150	200	250
Act Model	C		B									
BA13	170	125	135	145	170	185						
BA23	255			180	205	220	240	260	285	320		
BA33	338			205	230	245	265	285	310	340	395	480
BA63	415					290	310	335	365	415	500	
BA73	462						320	345	375	425	510	585
BA83	570						390	420	470	555	625	
	A											
	114	123	133	165	196	222	260	313	364	414	529	645