

Model GS54 HW

DIAPHRAGM VALVES

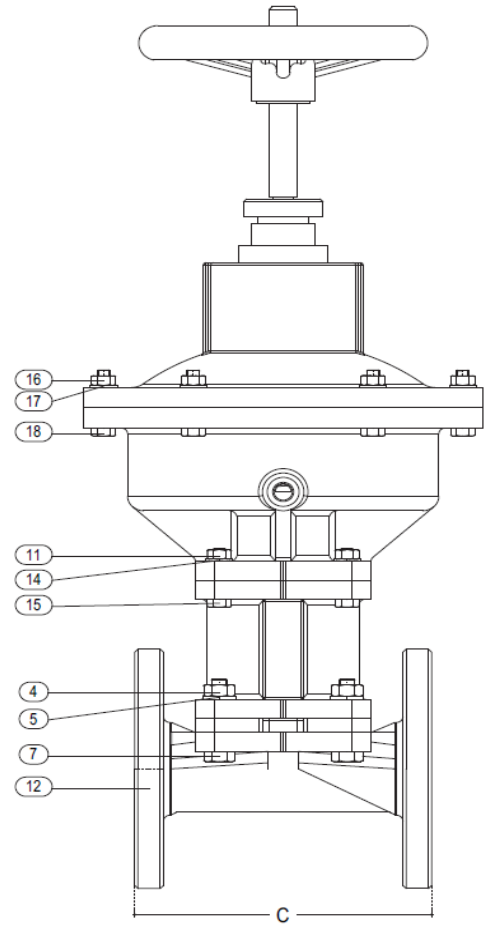
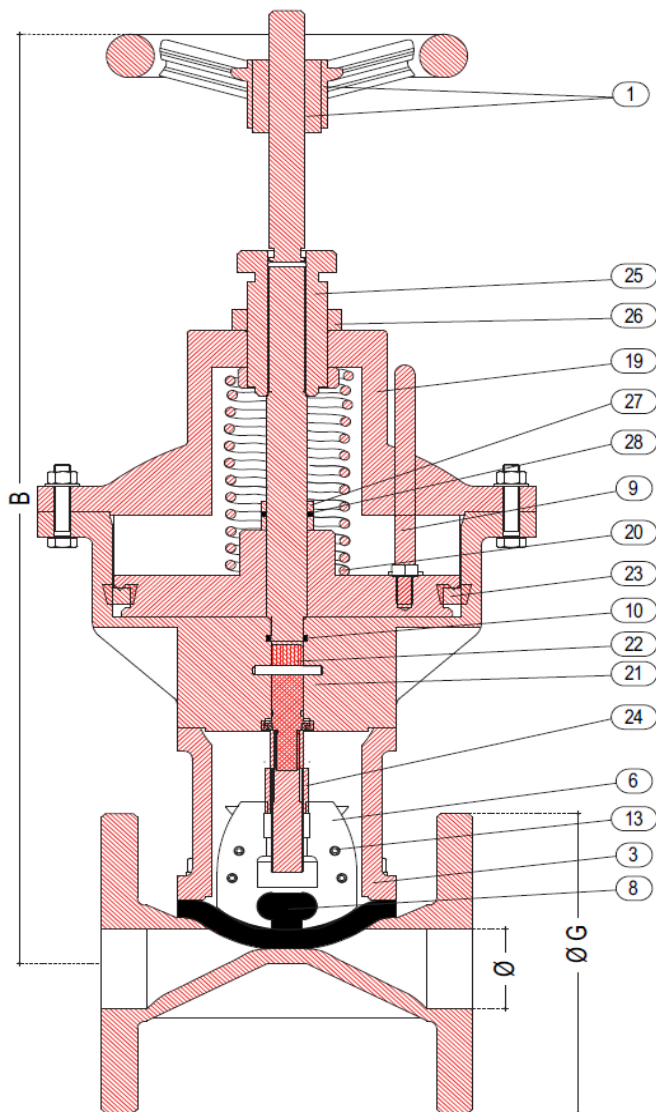

DETAILS

1	WHEEL AND BUSHING
3	SUPPORT
4	HEXAGON NUT
5	WASHER
6	PLUG
7	HEXAGON BOLT
8	DIAPHRAGM
9	GUIDE PIN
10	"V" GASKET
11	HEXAGON NUT
12	VALVE BODY
13	CLAMPING
14	WASHER
15	HEXAGON BOLT
16	HEXAGON NUT
17	WASHER
18	HEXAGON BOLT
19	COVER
20	SPRINGS
21	CYLINDER
22	PISTON, PIN AND LEAD SCREW
23	"V" GASKET
24	HEXAGON NUT
25	REGULATOR WHEEL
26	BUSHING
27	WHEEL
28	WITH

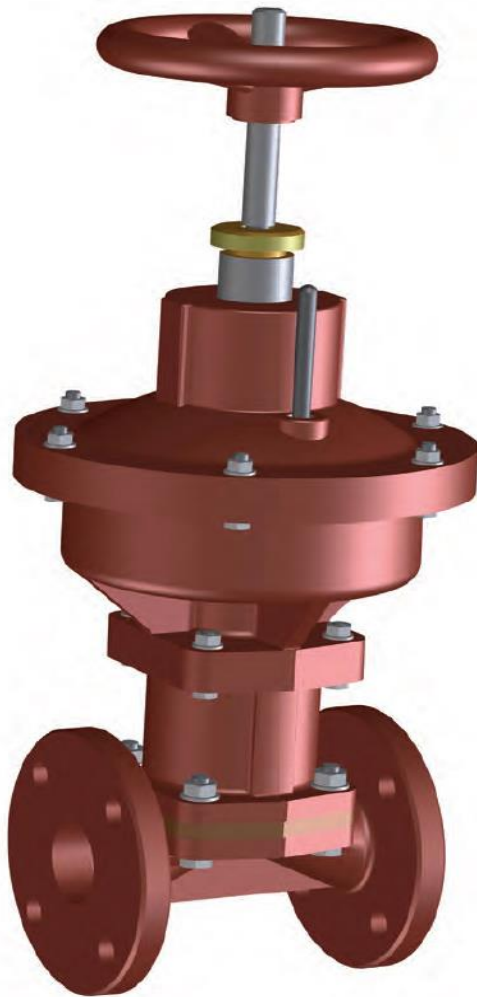

AIR PRESSURE REQUIRED KG/CM ²											
dn	20	25	30	40	50	60	75	100	125	150	200
min.	4	4	4	4	4	4	3,5	3,5	3	3	2,5
max.	6	6	6	6	6	6	5	5	5	4	4

PRESSURE DETAILS UNI_1284				
DN	P.N.	HYDRAULIC TEST kg/cm ²		WORKING PRESSURE kg/cm ²
		OPEN	CLOSE	
20	4,5	15	4,5	4
25	4,5	15	4,5	4
30	4,5	15	4,5	4
40	4,5	15	4,5	4
50	4	15	4,5	3
60	4	15	4,5	3
75	4	15	4,5	3
100	3,5	15	3,5	2,5
125	3,5	13	3,5	2,5
150	3	13	3	2
200	2,5	13	2,5	1,5

NOTE: For different pressure details please ask the DPT

WEIGHT KG	
C.I. unlined	C.I. ebonite lined
8,400	8,500
8,700	8,800
12,700	12,800
14,300	14,800
20,000	21,000
26,600	27,600
34,800	35,800
55,500	58,500
77,000	78,000
95,300	97,300
187,000	189,000

DIMENSIONS C.I. UNLINED				
Ø	B	C	G (UNI)	G (ASA)
20	360	117	105	98
25	360	127	115	108
30	410	146	140	118
40	450	159	150	127
50	520	190	165	152
60	590	217	185	178
75	620	254	200	190
100	780	305	220	229
125	960	356	250	254
150	990	406	285	280
200	1300	520	340	343

DIMENSIONS C.I. EBONITE LINED				
Ø	B	C	G (UNI)	G (ASA)
20	360	123	105	98
25	360	133	115	108
30	410	152	140	118
40	450	165	150	127
50	520	196	165	152
60	590	227	185	178
75	620	260	200	190
100	780	313	220	229
125	960	364	250	254
150	990	414	285	280
200	1300	530	340	343