

THE ANSWER TO PROBLEMS OF: CORROSION, ABRASION, CLOGGING, CONTAMINATION, VACUUM & GAS HANDLING

G&O Diaphragm valve do not incorporate any stuffing box and are leaktight on all liquids, slurries, granular materials, powders, pastes, gases, acids etc.. Diaphragm (internal membrane) is supported during opening and closing, and is easily replaceable without any special tools. The wide range of available elastomer materials enable an appropriate selection for each application and is a guarantee of perfect resistance to corrosion and abrasion. Sanitary type valves are recommended for ultimate sterility in pharmaceuticals and biotechnology industries. Using perfectly contoured self-draining stainless steel bodies and PTFE faced diaphragms, resulting in valves totally free of bacteria traps

PRODUCT FEATURES

- Weir type, conveyed flow way - Full bore type, straight through way
- Sanitary type
- Flanged valves sized from 1/2" through 14"
- Sanitary type (buttweld, screwed, tri-clamp, socket) sized from 1/2" through 4"
- manual, pneumatic and electric operators

PERFORMANCE FEATURES

- Long diaphragm life: no metallic inserts to strain the elastomers
- Low pressure loss
- Diaphragm supported during opening and closing: hence the possibility of under vacuum operation
- Quick and easy replacement of diaphragm
- Epoxy painted, valve bodies protected with an anti-acid varnish

BODY VALVE MATERIALS

- cast Iron gg20 or gg 25 (uni Iso 185/uni 5007) as per astm a126
- ductile or spheroidal cast Iron gs400/12 (uni Iso 1083/uni4544) as per astm a536
- cast steel wcb (a216m-93) as per astm a216 wcb
- carbon steel lcb as per astm a352
- stainless steel 316 (a743m-98) as per cf8m
- pure aluminium
- PVDF, PPH

BODY VALVE LINING MATERIALS

- Soft rubber
- Butyl rubber
- Hard rubber (ebonite)
- ECTFE/HALAR
- PFA
- ETFE
- Galvanized (laid in an hot zinc bath)

BODY EXTERNAL & INTERNAL SURFACE

(for sanitary type only)

- Satin or Vacuublast finished for external
- Vacuublast, Satin, Mirror or Supermirror finished for Internal

MATERIAL DIAPHRAGM

- Natural rubber
- White natural rubber
- Neoprene
- EPDM
- Viton
- Butyl
- Nitrile
- Hypalon
- Silicone
- Neoprene/Silicon (mixed)
- PTFE faced

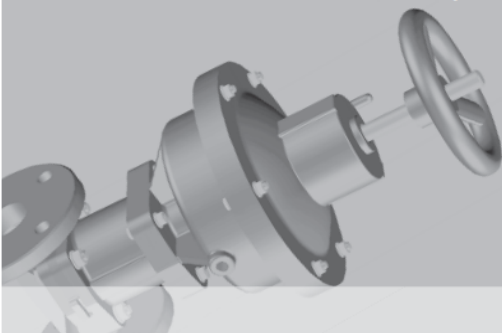

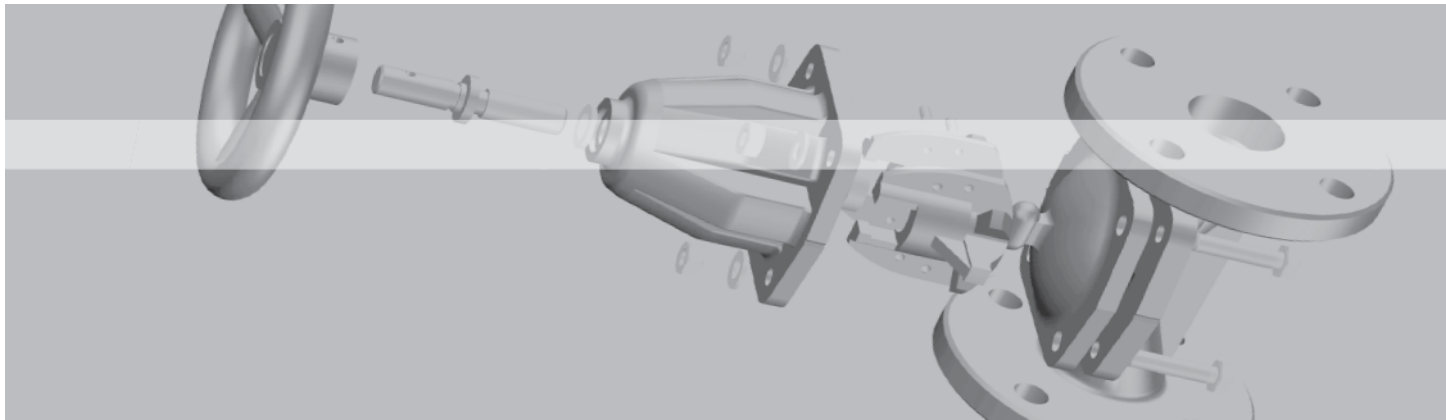

DESIGN/DIMENSIONS APPLICABLE STANDARD

- BS 5156
- DIN 3202 F1

END CONNECTIONS APPLICABLE STANDARD

- ANSI/ASME B16.5 Flanged Valves
- ANSI/ASME B16.1 Flanged Fittings
- ANSI/ASME B1.20.1 (NPT) Pipe Threads
- ANSI/ASME B16.34 Steel Valves
- ANSI/ASME B16.11 Socketweld Fittings
- MSS SP-88 Diaphragm Valves
- ANSI/ASME B16.25 Butt weld Ends

CERTIFICATES AVAILABLE

- EN 10204 3.1.B
- EN 10204 2.2
- GHOST-R

INSPECTION TESTS AVAILABLE BY

- SGS GLOBAL TRADE SOLUTIONS
- ITS INTERTEK TESTING SERVICES
- BV BUREAU VERITAS

MAIOR MARKETS SERVED

- Chemical process
- Mining
- Pharmaceutical
- Power generation
- Pulp & Paper
- Food & Beverage
- Water treatment
- Nuclear
- Bioprocess

OPTIONS

- Limit switches
- Solenoid valve
- Position Indicator
- Air filter regulator
- 3:1.5 PSI positioner
- 4:20mA electropneumatic positioner or 4:20mA electronic transmitter of position 30°-90° angle
- Mono/Triphase AC motor (240V/50Hz through 400V/50Hz)

G&O SERIES PNEUMATIC ACTUATORS

Piston type air operators line offer a great solution to a wide range of actuation situations. They are exclusively designed to G&O series butterfly valves and can be mounted in any position. These actuators are built in aluminium and are available in three options:

- single effect acting - fail to close (air to open)
 - single effect acting - fail to open (air to close)
 - double effect acting - fail to open & fail to close
- Single effect acting actuators are fitted by an extractable handwheel for security.

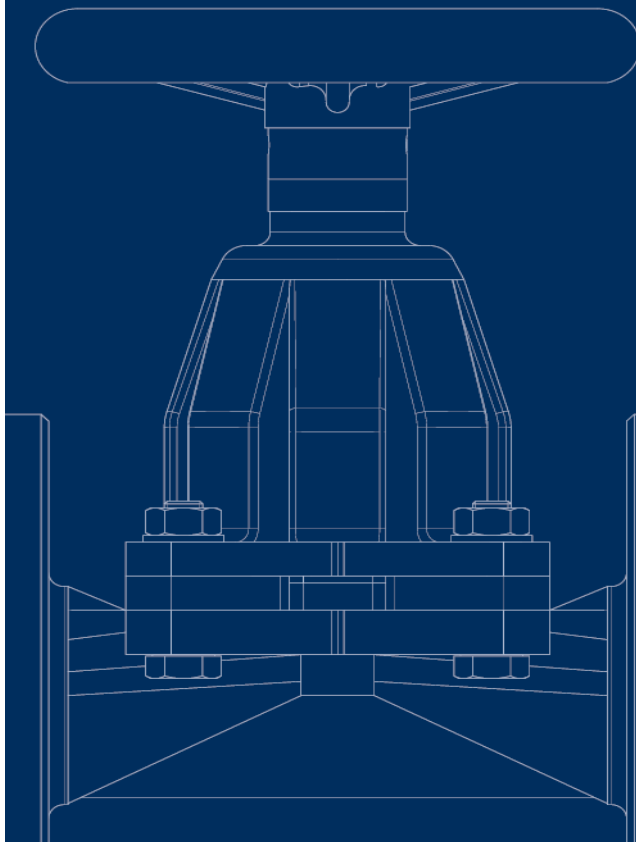

Model GS51 HW

DIAPHRAGM VALVES

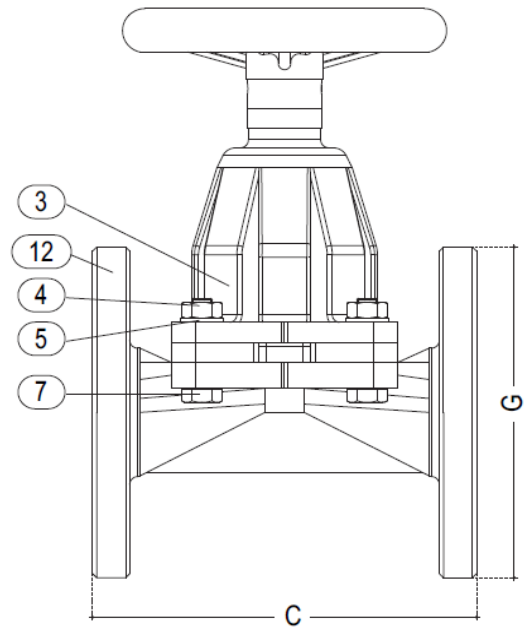
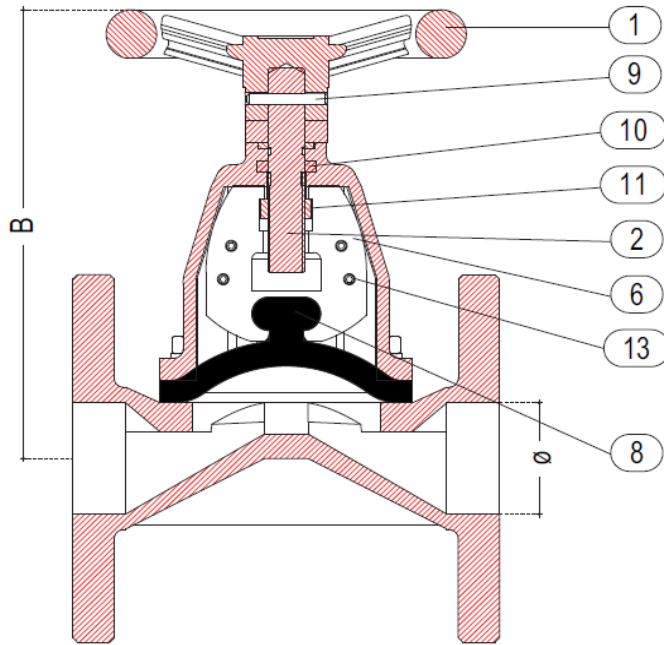

DETAILS	
1	CONTROL WHEEL
2	LEAD SCREW
3	COVER
4	HEXAGON NUT
5	WASHER
6	PLUG
7	STUD BOLT
8	DIAPHRAGM
9	SOCKET
10	GASKET
11	BRONZE NUT
12	VALVE BODY
13	CLAMPING SCREW FOR BUSHING

PRESSURE DETAILS UNI_1284				
DN	P.N.	HYDRAULIC TEST kg/cm ²		WORKING PRESSURE kg/cm ²
		OPEN	CLOSE	
15	14	15	14	13
20	14	15	14	13
25	14	15	14	13
30	13	15	13	12
40	12,5	15	12,5	11,5
50	12,5	15	12,5	11,5
60	11	15	11	10
75	10,5	15	10,5	9,5
100	10,5	15	10,5	9,5
125	9	13	9	8
150	8,7	13	8,7	7,7
200	7	13	7	6
250	6	8	6	6
300	6	8	6	6

NOTE: For different pressure details please ask the DPT

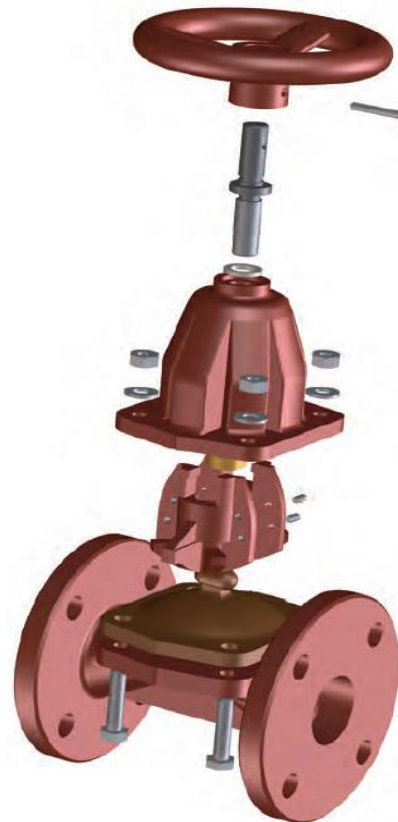

WEIGHT KG	
C.I. unlined	C.I. ebonite lined
2,300	2,400
3,800	3,900
4,000	4,100
6,600	6,700
8,000	8,300
12,000	12,400
17,000	17,600
23,000	24,000
36,500	98,000
56,000	55,700
76,500	76,200
144,000	142,000
225,000	226,000
330,000	350,000

DIMENSIONS C.I. UNLINED				
Ø	B	C	G (UNI)	G (ASA)
15	87,5	108	95	90
20	112,5	117	105	98
25	117,5	127	115	108
30	135	146	140	118
40	170	159	150	127
50	187,5	190	165	152
60	232,5	217	185	178
75	260	254	200	190
100	315	305	220	229
125	400	356	250	254
150	442,5	406	285	280
200	585	520	340	343
250	655	635	395	406
300	718	749	445	483

DIMENSIONS C.I. EBONITE LINED				
Ø	B	C	G (UNI)	G (ASA)
15	92,5	114	95	90
20	117,5	123	105	98
25	122,5	133	115	108
30	140	152	140	118
40	175	165	150	127
50	192,5	196	165	152
60	237,5	227	185	178
75	265	260	200	190
100	320	313	220	229
125	405	364	250	254
150	447,5	414	285	280
200	590	530	340	343
250	660	645	395	406
300	723	759	445	483