

Actuator Type 2, Features and Benefits

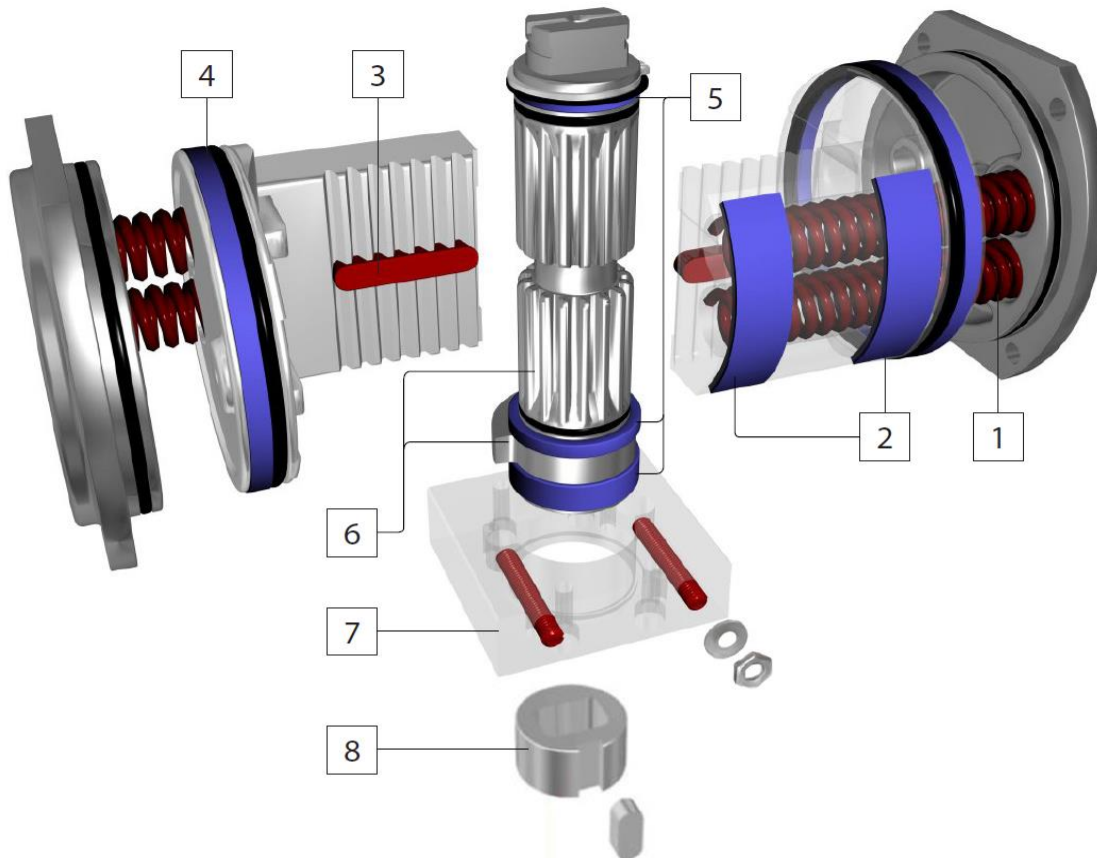

1. SPRINGS

- Springs are located inside the piston rack, same overall dimensions for DA and SR actuators.
- No special tools required to change from DA to SR or opposite.
- Long bolting is standard feature to fully relax springs.

2. PISTON WEAR PADS

- Dual encapsulated "POM" wear pads on the piston, prevent metal to metal contact between piston and cylinder, thus providing low friction travel.
- The dual encapsulated "POM" wear pads absorb the adverse side loading at start of each stroke.

3. TWIN GUIDE BARS

- Twin guide bars absorbs any adverse side loading, from rack at the start of each stroke, which reduces pinion & rack wear.

4. BACK UP BEARING

- Piston back up bearings, which are situated behind the pistons "o" ring, ensure linear movement and prevent wear on the cylinder surface.

5. TRIPPLE SHAFT BEARING

- Triple shaft bearing to prevent any adverse loading on the driveshaft

6. DRIVESHAFT & CAM

- The shaft and adjustment cam are machined from solid bar material.
- The cam mechanism allows for 2.5° over travel in both directions.
- The inner depth of the driveshaft allows for total engagement of any valve shaft height for direct mounting.

7. BODY ADAPTOR KIT

- Integral Body Adaptor Kit (BAK), interchangeable with a wide range of valves for direct mounting by using an interchangeable insert sleeve, is retained by a circlip.
- Dual end stop adjustments are integral to the body adaptor and operate in conjunction with the machined cam on a single piece driveshaft, remaining outside the pressurized cylinder.

8. INSERT SLEEVE

- Manufacture from stainless steel bar, can be rotated for cross and parallel mounting. The insert is held inside the driveshaft by means of a circlip.

Body Adaptor Kit Assembly Instructions

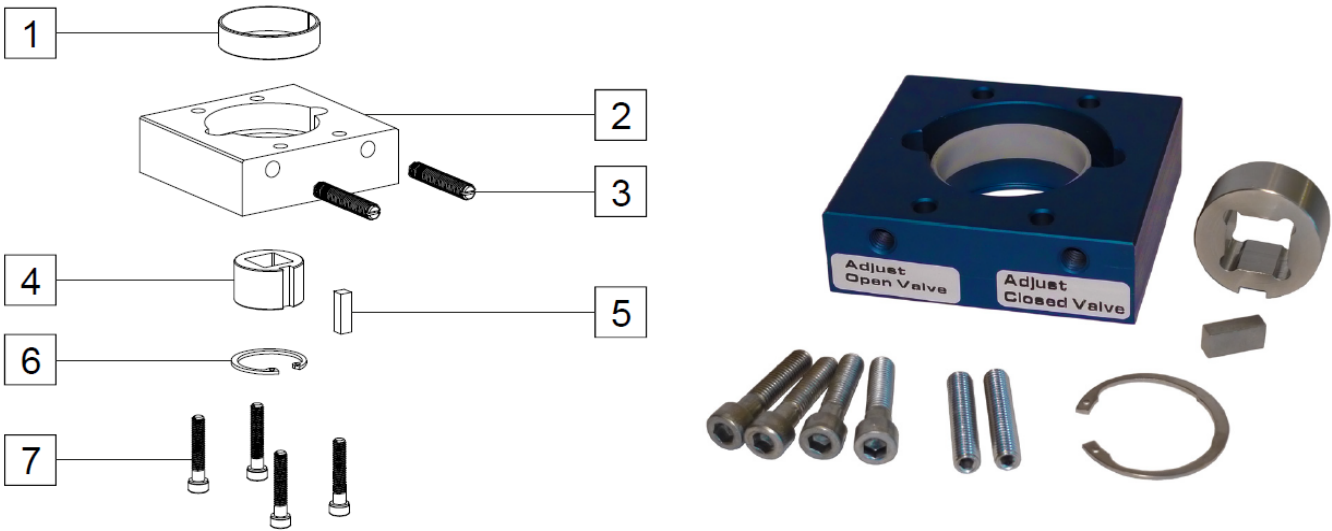

BODY ADAPTOR KIT DIS-ASSEMBLY

- Remove retainer circlip (6) to allow removal of insert sleeve (4) and insert key (5).
- Remove 2 x stop screws (3) from body adaptor.
- Remove 4 x bolts (7) from body adaptor (2).
- Gently remove body adaptor (2) ensuring stop adjustment bearing (1) is also removed and placed into body adaptor (2) after dis-assembly.

BODY ADAPTOR KIT ASSEMBLY

- Insert body adaptor bearing (1) into body adaptor (2) and apply a small amount of grease.
- Place body adaptor (2) over driveshaft ensuring stop screw holes are facing the front of the actuator (same position as air inlet ports).
- Insert 4 x body adaptor bolts (7) into body adaptor (2) and fasten.
- Insert 2 x stop screws (3) and adjust to required position.
- Place insert sleeve (4) and key (5) ensuring it is in the correct orientation (in-line or cross mount).
- Replace retainer circlip (6) to secure insert sleeve (4) and key (5).

Stop Screw Turns Required from Screw being Flush with BAK

	20 F07	35 F07	35 F10	55 F10	55 F12	70 F10	70 F12	100 F14	150 F14
0° Closed	11.60	10.00	10.00	13.30	13.30	13.30	13.30	16.00	16.00
90° Open	11.60	10.00	10.00	13.30	13.30	13.30	13.30	16.00	16.00
0-2.5° Adj.	0.96	1.06	1.06	1.25	1.25	1.25	1.25	1.22	1.22