

# Limit Switch Inductive sensor Type IFM NN5013

- IND2004DN/BS/1D/1G/2G
- Inductive sensor
- Connector
- ATEX approval
- Group II, category 1D
- Group II, category 1G/2G
- Sensing range 4 mm
- non-flush mountable

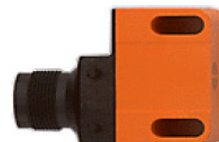

## TECHNICAL DATA

Electrical design	Connection to certified intrinsically safe circuits with the max. values U = 15 V / I = 50 mA / P = 120 mW
Output	2 x normally closed
Nominal voltage (V)	8.2 DC (1kΩ)
Supply voltage (V)	7.5...15 DC
Current consumption (mA)	< 1 *
Internal capacitance (nF)	< 140 **)
Internal inductance (μH)	< 130 **)
Real sensing range (mm)	4 ± 10 %
Switch-point drift (% of Sr)	-10...10
Hysteresis (% of Sr)	1...15
Switching frequency (Hz)	1800
Correction factors	mild steel = 1 / stainless steel approx. 0.7 / brass approx. 0.5 / Al approx. 0.4 / Cu approx. 0.3
Ambient temperature (°C)	-20...80
Protection	IP 67, III
Shock / vibration resistance	30g (11 ms) / 10-55 Hz (1 mm)
EMC	EN 60947-5-6
Approval	DMT 02 ATEX E028 BVS 04 ATEX E153 IECEX BVS 06.0003
Marking of the unit	II 1D Ex iaD 20 T 90°C Ta: -20...70°C II 1G Ex ia IIB T6 Ta: -20...70°C II 1G Ex ia IIB T5 Ta: -20...80°C II 2G Ex ia IIC T6 Ta: -20...70°C II 2G Ex ia IIC T5 Ta: -20...80°C Ex ia IIB T6 zone 0 Ta: -20...70°C Ex ia IIC T6 zone 1 Ta: -20...70°C
Housing materials	housing: PBT; cover: PC
Function display Switching status	LED 2 x yellow
Connection	M18 connector
Weight (kg)	0.083
Remarks	* ) damped; (> 2.1 mA undamped) ** ) per intrinsically safe circuit



## DIMENSION

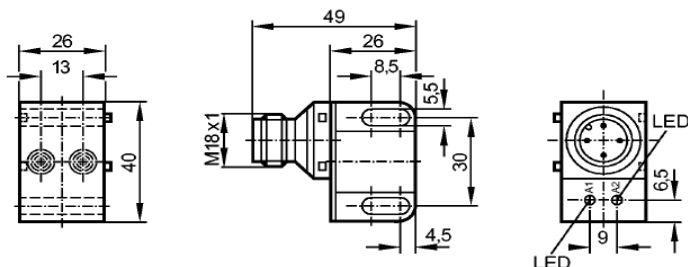

## WIRING

