

Limit Switch box, Type ITS110, Inductive

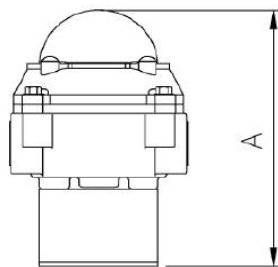

DIMENSIONS (mm)

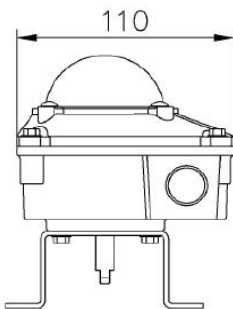
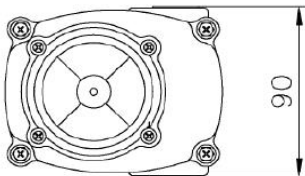

| A | Type 1 | Type 2 |
|-----|---------|--------|
| 136 | 2-35 | - |
| 146 | - | 35-150 |
| 166 | 250-400 | - |

SPECIFICATIONS

| | |
|---------------------|--|
| Enclosure | Weatherproof IP67, O-ring sealed |
| Material | Aluminum, Polyester coated |
| Ambient temperature | -20°C~+80°C |
| Switch cams | Adjustable, preset for 90° |
| Cable entries | 2xM20x1.5 |
| Terminal block | 8 pos of terminal strips (6 for switches, 2 for solenoid valve power) |
| Position indicator | Dome type 0°~90° |
| Mounting bracket | Stainless steel acc. to VDI/VDE3845, NAMUR |
| Proximity sensors | 2 pcs. type V3, IFM IS 5001, 10-36V DC PNP |