

## Push-in Couplings

The connection between the tube and the fitting ensure a total tightness even in severe conditions such as impact and vibrations.

### Push-in Coupling for plastic tubes, Type 50020

Straight

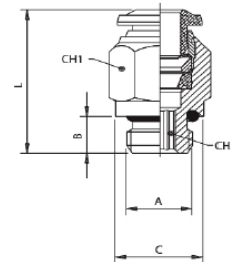

Size	Slang	A	B	C	L	CH1	CH2
1/8"	4	1/8	6	13	20,0	10	3
1/8"	6	1/8	6	13	23,5	13	4
1/4"	6	1/4	8	16	23,5	13	4
1/8"	8	1/8	6	13	25,0	14	5
1/4"	8	1/4	8	16	23,0	14	6

### Push-in Coupling for plastic tubes, Type 50116

Angled

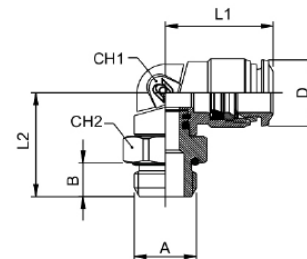

Size	Slang	A	B	L1	L2	CH1	CH2	D
1/8"	4	1/8	5,4	18,0	16,4	9	13	10,0
1/8"	6	1/8	5,4	21,0	18,1	11	13	12,5
1/4"	6	1/4	7,1	21,0	19,8	11	16	12,5
1/8"	8	1/8	5,4	22,5	20,1	12	13	14,5
1/4"	8	1/4	7,1	22,5	20,3	12	16	14,5